

SCMCES TRAINING SERIES

STAAD PRO for Civil & Structural Engineers

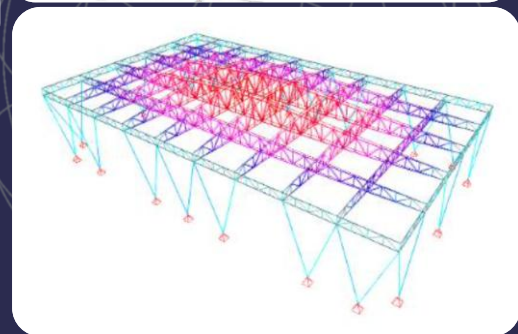

SCMCES provides consultancy services for civil infrastructure, including Structural Analysis Design, Review, Audit, Remedial Engineering, Advanced Rehabilitation Technologies(ART), Structural Health Monitoring (SHM) services as well as research and training in related engineering domains.

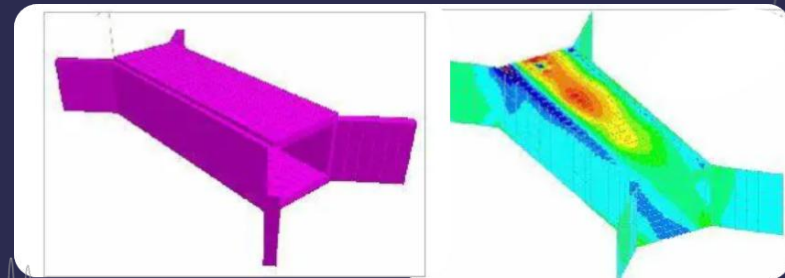
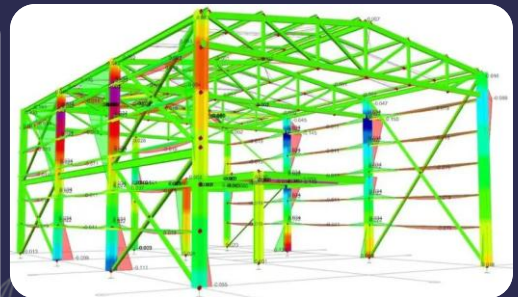
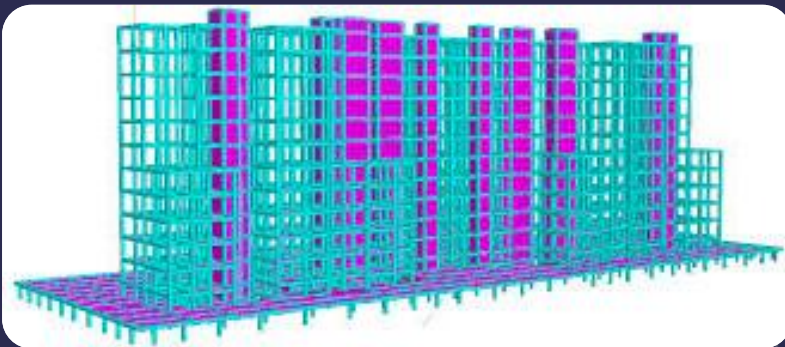

+91-84314 22882



scmc.es.consultants@gmail.com



www.scmc.es.com

“Engineering Insight ❖ Monitoring Integrity ❖ Building Futures”

STAAD.Pro for Civil and Structural Engineers

Analyse with Clarity. Design with Confidence.

About the Course

This course is aimed at civil and structural engineers who wish to **apply structural analysis and design principles effectively using STAAD.Pro**, a widely used structural analysis software for **buildings, industrial structures, bridges, towers, and special structures**.

STAAD.Pro supports **linear and non-linear analysis, static and dynamic loading, and multi-material design**. However, **accurate results depend on correct modelling philosophy, load application, boundary conditions, and engineering interpretation**. This program presents a **systematic, engineering-first roadmap** from problem definition to design output.

No prior STAAD.Pro experience is required. A basic understanding of **structural analysis, strength of materials, and design concepts** is assumed. The course is suitable for **freshers, practicing engineers, and professionals seeking structured upskilling or validation**.

Who Should Attend

Civil Engineers | Structural Engineers | Post-graduate students |
Final-year engineering students | Fresh Graduates | Practicing Professionals

SCMCES Training benefits

- ✓ Engineering-led training approach
- ✓ Practical civil & structural case studies
- ✓ Application-oriented learning
- ✓ Professional certification on completion

How the Training Works

- Conceptual explanation of analysis & design fundamentals
- Live demonstrations using **STAAD.Pro**
- Hands-on modelling and analysis exercises
- Engineering case studies from real projects
- Common mistakes, best practices, and validation techniques

Training batch details

- Batch starts : Every Quarterly
- Training Mode : Online/ Offline / Hybrid
- Course duration : 40 Hrs. (2~3 -hour session per day)
- Enquire Now | Book Your Seat : +91 8431 42 28 82

scmc.es.consultants@gmail.com

Disclaimer: STAAD.Pro is a registered product of Bentley Systems. This training is independent and application-oriented.

STAAD.Pro for Civil and Structural Engineers

Analyse with Clarity. Design with Confidence.

Course Topics & Modules

- **Introduction to Structural Analysis Concepts**
Behaviour of frames, trusses, space structures
- **Getting Started with STAAD.Pro**
Interface, modelling workflow, coordinate systems
- **Structural Modelling in STAAD.Pro**
Nodes, members, supports, releases, offsets
- **Material Properties & Section Definition**
Concrete, steel, user-defined sections
- **Load Definition & Load Combinations**
Dead, live, wind, seismic, moving loads
- **Static & Advanced Analysis**
Linear static, P-Delta, second-order effects
- **Dynamic Analysis**
Seismic analysis, response spectrum basics
- **Design Modules in STAAD.Pro**
RCC and steel design, code checks, reports
- **Result Interpretation & Validation**
Forces, moments, deflections, utilization ratios
- **Engineering Documentation & Coordination**
Reporting, stakeholder communication, design review readiness



What Participants Receive

- Step-by-step STAAD.Pro modelling examples
- Load combination & design command templates
- Analysis interpretation guidelines
- Modelling & validation checklists
- Course completion certificate from SCMCES

Training batch details

- Batch starts : Every Quarterly
- Training Mode : Online/ Offline / Hybrid
- Course duration : 40 Hrs. (2~3 -hour session per day)
- Enquire Now | Book Your Seat : +91 8431 42 28 82

scmc.es.consultants@gmail.com

Disclaimer: STAAD.Pro is a registered product of Bentley Systems. This training is independent and application-oriented.